



About the company

Since its establishment Orion systems has been one of the leading battery manufacturer. Through a relentless commitment to quality and continuous improvement, the company has gone from strength to strength. Over a period, Orion has established itself as a brand with a reputation for Reliability, Consistent Performance and Excellent Durability.

From a modest beginning of trading in automobile batteries Orion has come a long way. Induction of modern technology, constant upgradation and expansion, as well as a deep understanding of customer preferences and market trends, have together contributed to the company's enviable growth.

Today, Orion boasts of new generation manufacturing equipment. A highly motivated team of experienced professionals are the driving force behind Orion's determination to offer Fail-Proof batteries to its valued customers.

All this would not have been possible without the patronage and support of our customers. It is the end users we must thank & Orion pledges to make every effort to supply its customers with the highest possible quality products at best possible prices.

Applications

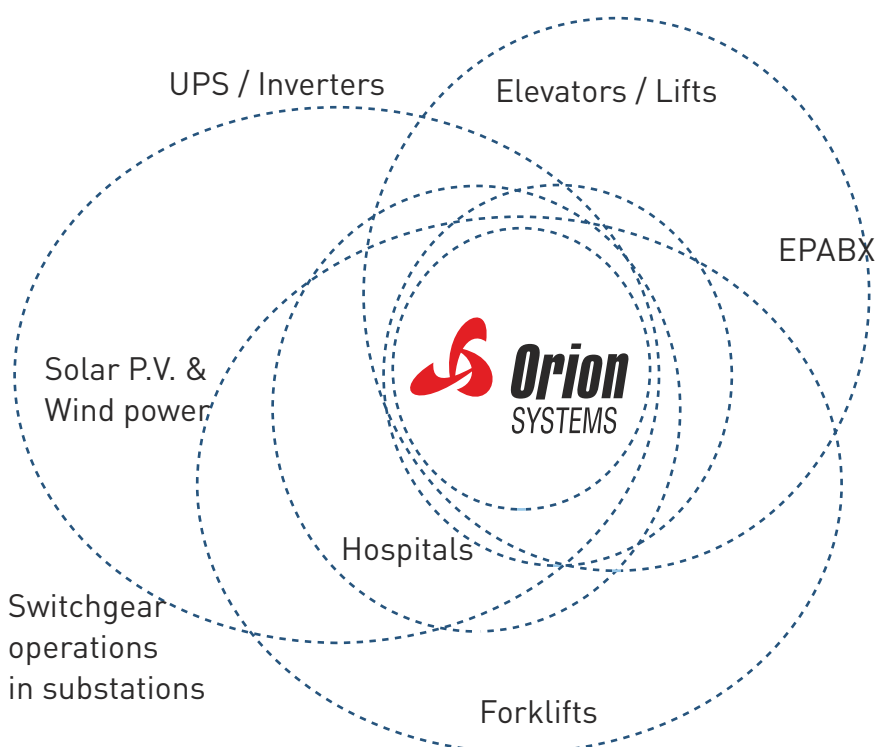

Construction & Salient features

P.P. Containers / Hard Rubber Containers

We offer two options i.e Polypropylene containers for aesthetic look and conventional rugged Hard Rubber containers

Pasted Negative plates

The negative plates are of pasted type. The active material is a blend of oxide, special additives and expanders which aid in better voltage built up and charging characteristics.

Aqua trap vent plugs

R.D.S.O. approved Aqua trap vent plugs are used to prevent electrolyte loss during charging and discharging of batteries.

Tubular positive plates

Our tubular positive plate grids are produced in state of art pressure die casting machines. Due to this we are in a position to manufacture these grids with special low antimony selenium hybrid alloy that are free from blow holes, have dense uniform grain structure, high mechanical strength and good dimensional accuracy. The active material is manufactured in house with imported virgin lead. The active material is encapsulated in between the grid and pluri tubular bag which snugly fits on to the grid and the open end is sealed with plastic bottom bars. This construction keeps the active material intact and prevents shedding of active material during long service life of the tubular battery.



Separators

Imported industrial grade Polyethylene separators are used. These separators are laser tested for detecting pin holes, they have good mechanical strength, porosity and low electrical resistance.

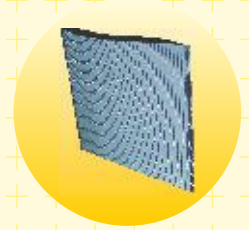

S.S. nut bolts

Ensures that there is no sulphation at the terminals.



L' shaped terminals

For easy installation.

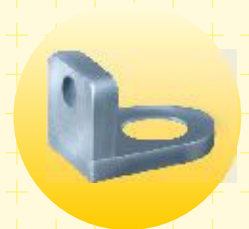

Dimensions

| | | Overall dimensions | | | Battery Weight (Kgs) | |
|--------|------------------------------------|--------------------|-----|-----|----------------------|--------|
| Type | Capacity @ 10Hr. End voltage 10.5V | L | W | H | Dry | Weight |
| TP 20 | 20 | 250 | 175 | 230 | 9 | 15 |
| TP 40 | 40 | 360 | 180 | 230 | 16 | 22 |
| TP 60 | 60 | 420 | 180 | 230 | 21 | 30 |
| TP 80 | 80 | 520 | 270 | 270 | 28 | 43 |
| TP 100 | 100 | 510 | 280 | 255 | 33 | 46 |
| TP 120 | 120 | 510 | 280 | 255 | 40 | 56 |
| TP 150 | 150 | 520 | 280 | 340 | 52 | 70 |
| TP 180 | 180 | 520 | 280 | 340 | 60 | 77 |
| TP 210 | 210 | 520 | 280 | 340 | 72 | 85 |

*The above dimensions & weight are approximate figures. Might change due to technical upgradation.

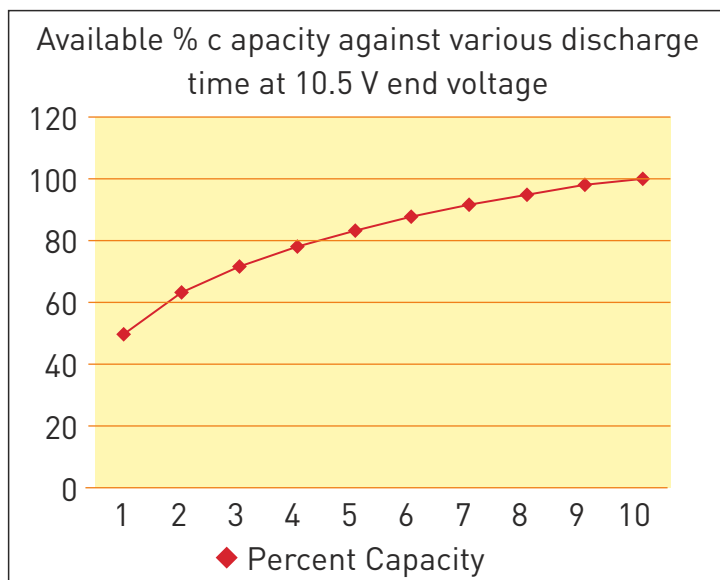

Effects of temperature

Battery life is decreased as temperature goes up and increased as temperature goes down. However, battery capacity is increased as temperature goes up and decreased as temperature goes down. Though, battery capacity increases at higher temperature life is shortened.

Hence it is advised to keep batteries in a cool and well ventilated pplace.

Handling Instructions :

- Batteries should be installed on an insulated surface such as sheet of rubber, plastic tray or wooden plank.
- Electrical connections at the terminals should be tight to prevent sparking or melting.
- Care should be taken not to short circuit the terminals while connecting them.
- Apply petroleum jelly to the terminals to prevent sulphation.
- Ventilation should be proper at the installation site.
- Do not bring hazardous material, flame, lighted cigarettes near the batteries.
- Keep the surface of the batteries clean & dry.
- Electrolyte level should be topped up periodically using distilled water. Never use acid to top up the battery at any time in the life of the battery.



B49, Tulshibaugwale Colony,
Sahakarnagr No. 2,
Pune 411 009.
Tel. +91 24225586 / 24225506
Mob. +91 8080996475
E-mail: orionsystemssales@gmail.com
www.orionsystemsups.com